























# Plan d'installation de chantier



Opération – siège URSSAF Pays de la Loire (44)

# Légende

Fluides			
Point de branchement eau		Point de branchement électricité	
Branchement eaux usées		Coupure gaz	
Coupure électricité			
Sécurité			
Barrières Heras		Monte charge	
Accès chantier		Accès personnel	
Issues de secours		Accès public	
Accès condamnés			
Installations de chantier			
Bungalows de chantier		Zone de stockage	
Bennes de chantier		Panneau de chantier	
Gestion des déchets		Atelier	
Stationnement			
Parking personnel		Parking chantier	



100

Période 10/2025 au 12/2026

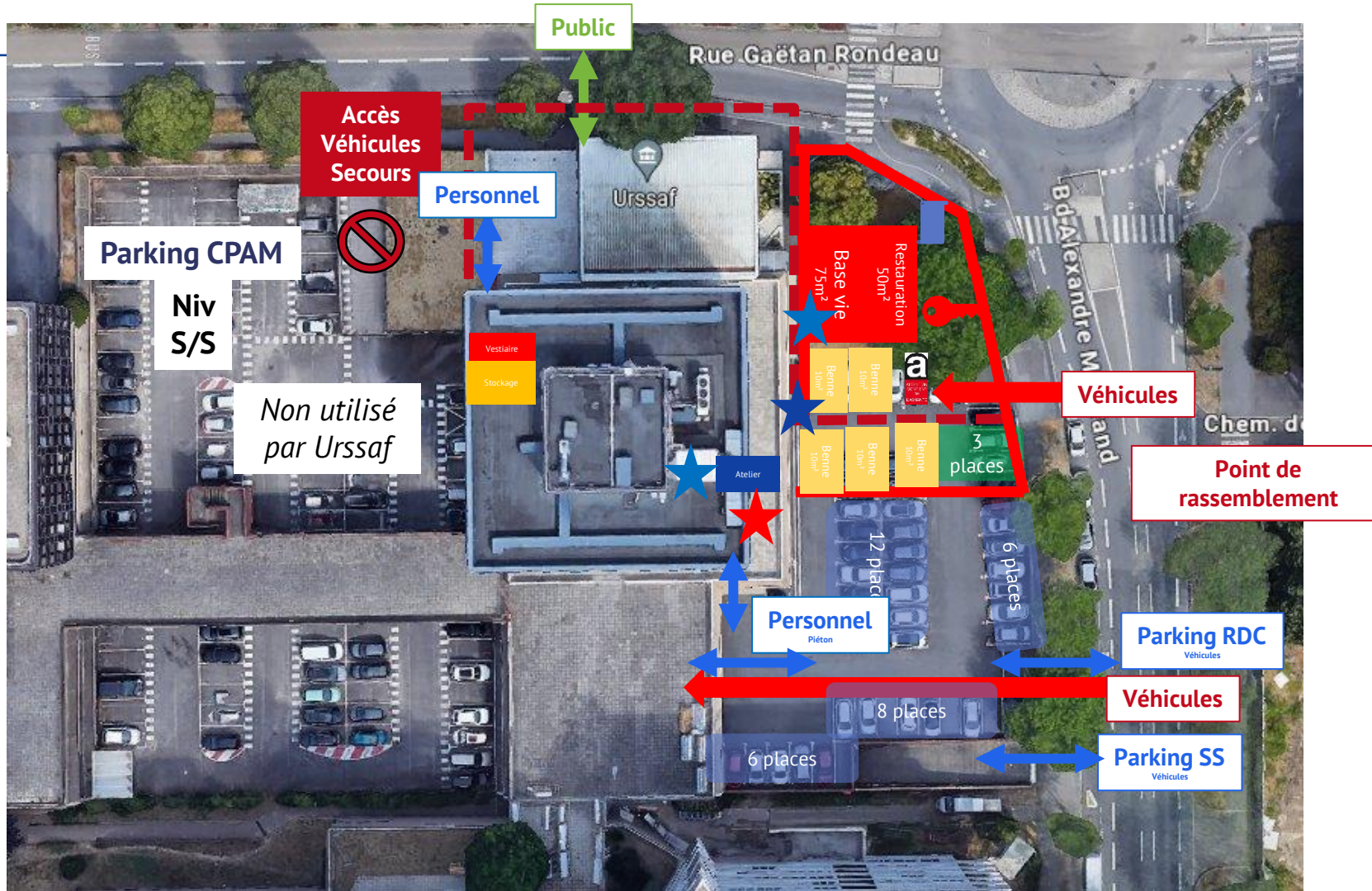

# Plan d'installation de chantier (RDC) – URSSAF

Période 10/2025 au 12/2026

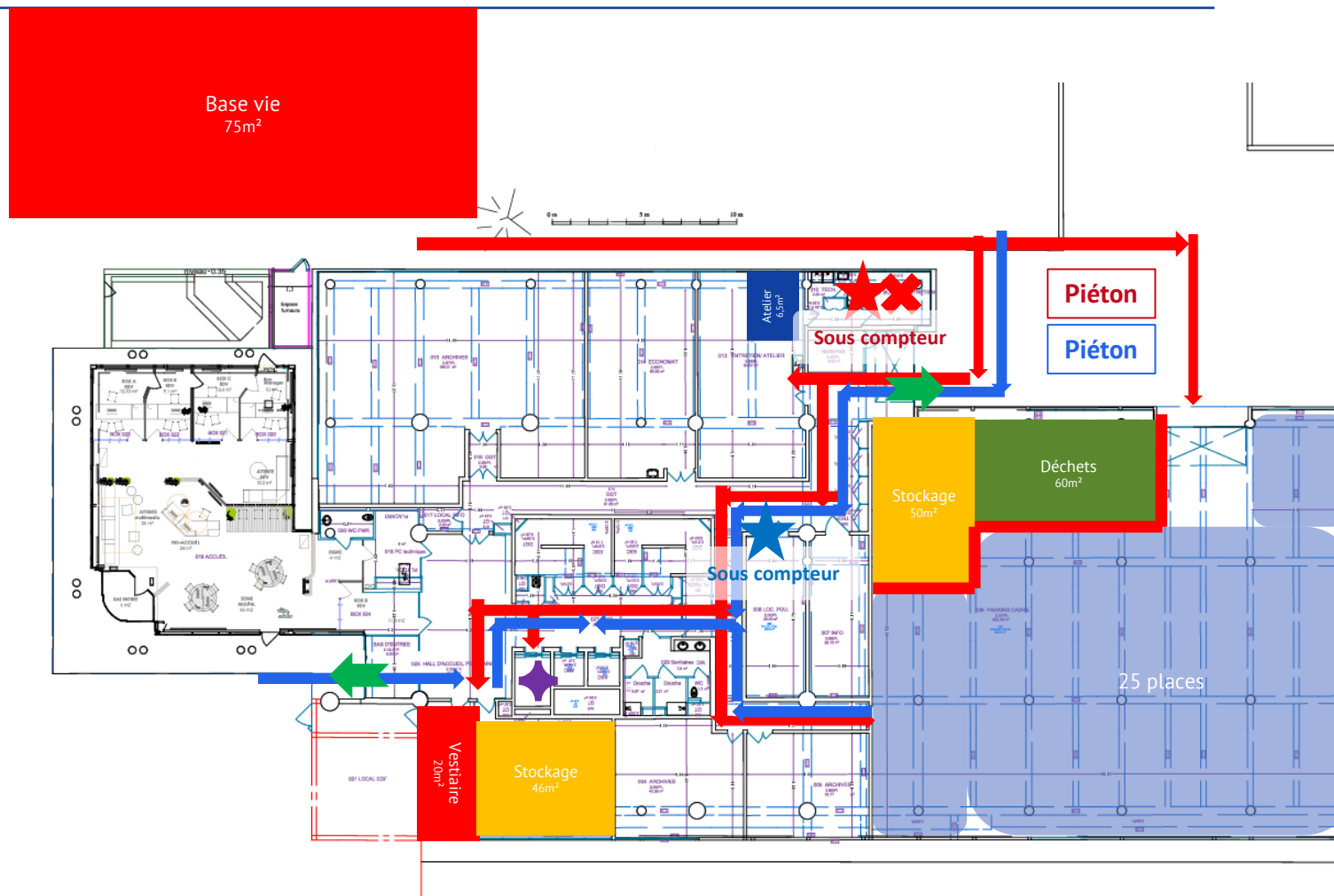

# Schéma parking aérien et couvert au RDC au sous-sols

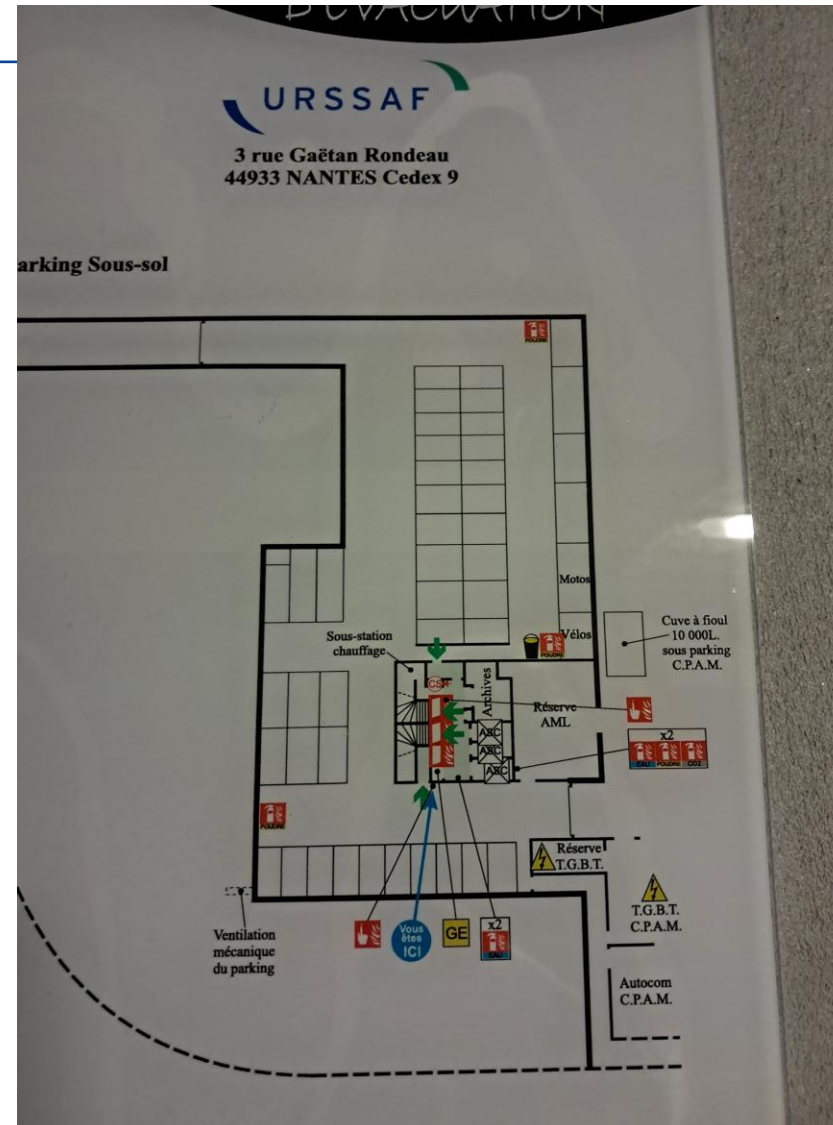
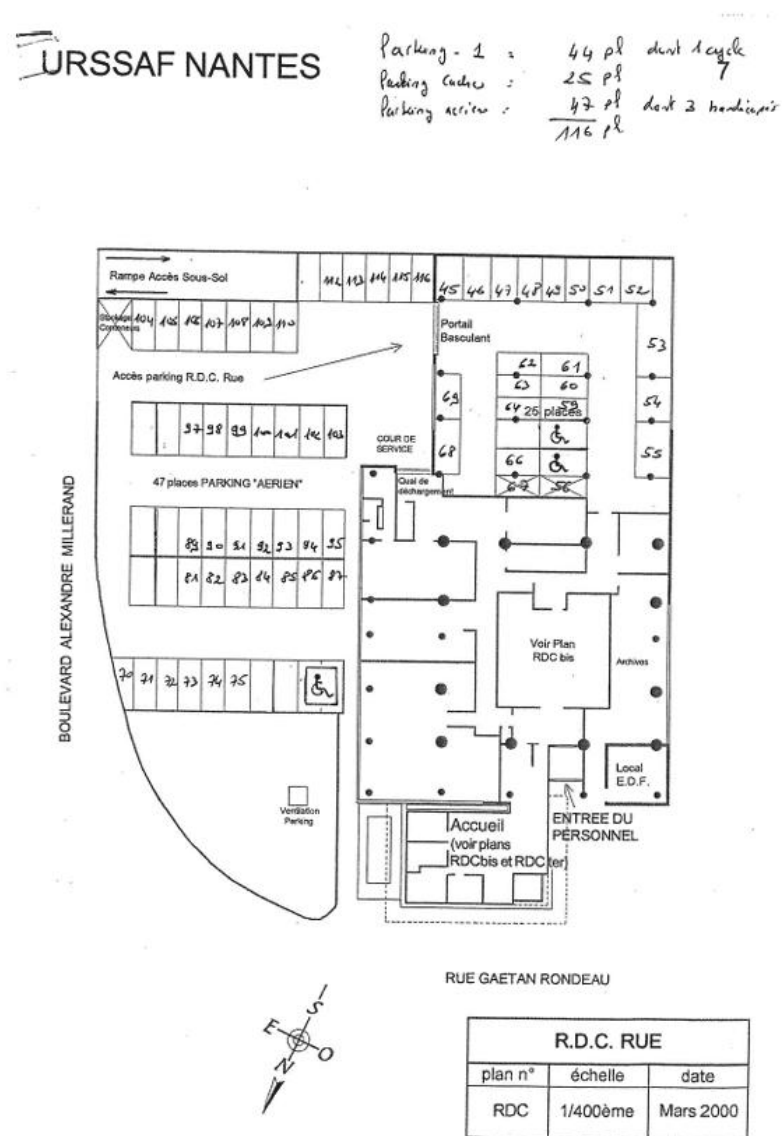



# Plan d'installation de chantier – URSSAF

Période 10/2025 au 12/2026

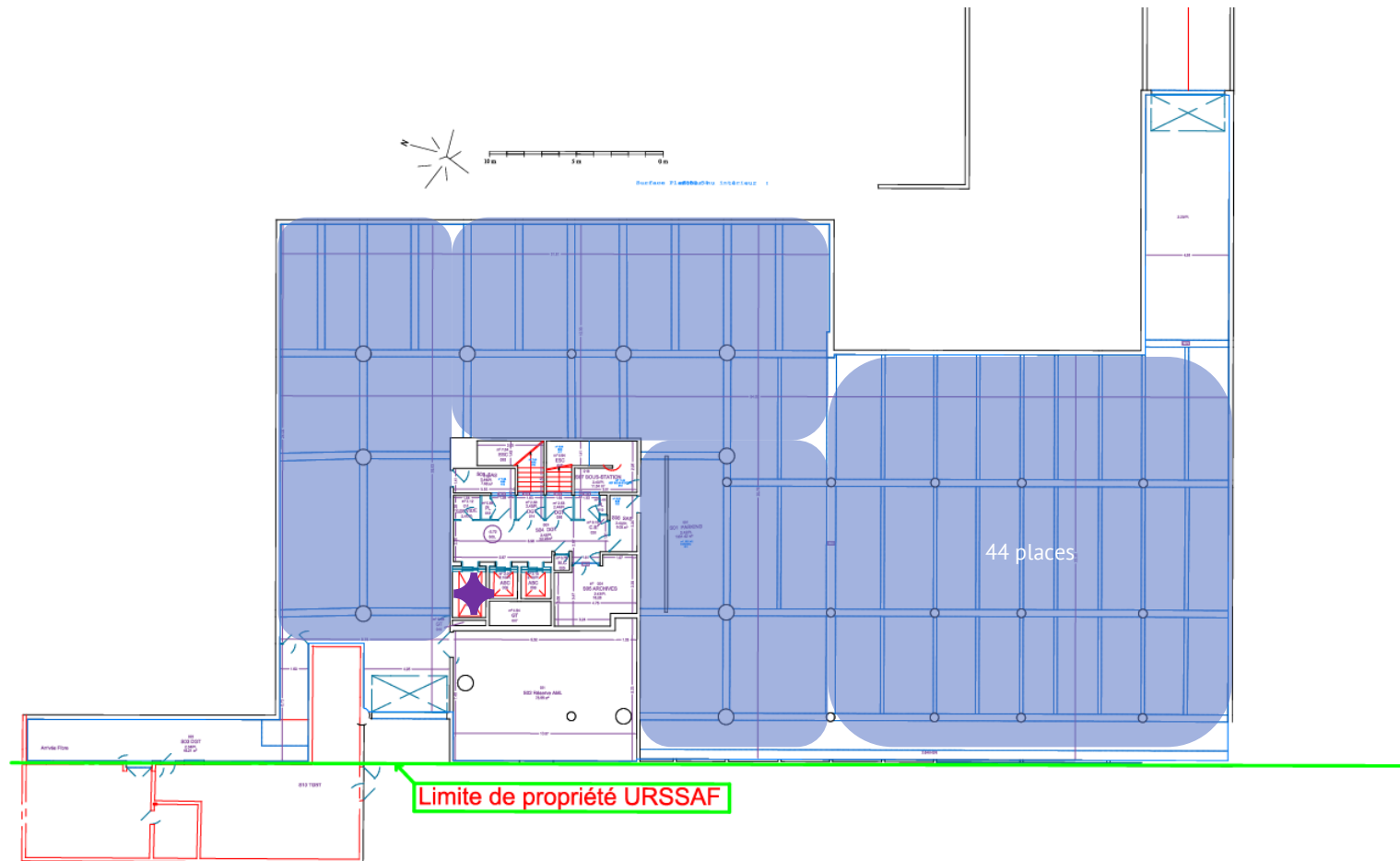

 Au service de notre protection sociale	Niveau: S/S	URSSAF NANTES 3 rue Gaetan rondeau S/S	Format : A3	N° :1
	Ech : 1/200		Date : 03/07/2023	



Période 10/2025 au 12/2026

